

Product Name	Planet Large
Product Number	RC-805
Size -- Length	5.02 m / 16' 6"
Size -- Width	5.02 m / 16' 6"
Size -- Height	5.43 m / 17' 10"
Shipping Weight	1385 kg / 3053.4 lb
Shipping Volume	3.60 m ³ / 127.1 ft ³
Foundations	4
Concrete Volume	1.37 m ³ / 48.4 ft ³

	ASTM F-1487	CSA Z614	EN 1176
Ages	5 years - 12 years	5 years - 12 years	6 years - 12 years
Safety Zone - Length	8.68 m / 28' 6"	8.68 m / 28' 6"	8.54 m / 28' 0"
Safety Zone - Width	8.68 m / 28' 6"	8.68 m / 28' 6"	8.54 m / 28' 0"
Fall Height	1.77 m / 5' 10"	1.77 m / 5' 10"	1.77 m / 5' 10"
Capacity	49	49	49

*Note: Concrete must be minimum 3500 PSI / 25MPa

SUPPORT POSTS

This will be 2 3/8" (60.5mm) steel tubing finished with polyester powder coating.

PIPE JUNCTIONS

These will be steel, 8" (200mm) diameter with integrated holes for pipe connections, finished with either polyester powder coating. Junction caps are affixed with stainless steel bolts.

CLIMBING NETS

These will be 20 mm diameter, polyamide (nylon) rope cable with UV protection and fire retardant solution. Each rope consists of 6 strands each containing 24 galvanized steel reinforcing strands within a polyamide sleeve, wrapped around a solid polyamide core for a total of 144 steel reinforcing strands; each end of the cable having a junction loop attached onto the cable with a finished aluminum sleeve and lined with a galvanized steel wear bar. Rope shall achieve a Class 7-8 Colourfastness rating..

BALL KNOTS

This will be a one-piece compressed aluminum ball, compressed in place with 150,000 pounds force (667KN) to prevent the connection from moving and causing premature cable wear.

BASIC FASTENERS

All fasteners for component attachments are stainless steel.

TENSIONING

Tensioning is achieved by way of a galvanized threaded eyebolt and shackle located at each Pipe Connection capable of drawing the cables a minimum of 4" (100mm).

FOUNDATION

These will be 10" (250mm) square steel plates, 1/8" (3mm) thick, bolted to concrete blocks and attached to the main structure with 12" (300mm) long, 2 3/8" (60.5mm) OD steel tubing, all finished with either polyester powder coating.

ANCHOR BOLTS

Mounting plates will be secured to concrete blocks with 7/8"(22mm) diameter x 20"(50mm) long "L" Anchor bolts, inserted into the wet concrete when poured.

SURFACE MOUNT

Optionally, the product may be surface mounted utilizing 6" (150mm) long expansion bolts in place of the standard anchor bolts.

INSTALLATION

This should be installed only by licensed playground installer, trained and certified on the relevant playground standards in place in the region of installation, e.g, NPSI, CPSI or similar certified.

COMPLIANT WITH

CAN/CSA-Z6 14-07
 ASTM F-1487-11
 EN-1176
 CPSC Handbook for Public Playground Safety



Support Posts

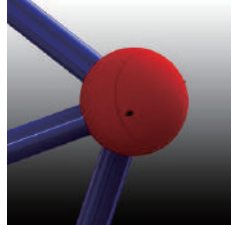

Pipe Junctions



Climbing Net - 20mm



Ball Knot



Shackle



Footing

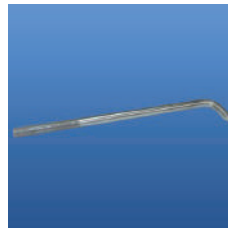

Anchor Bolt



Expansion Bolt